

SCOTTSDALE AIRPARK OFFICE/WAREHOUSE FOR LEASE 2,098± SF

100% HVAC

8260 E GELDING DRIVE | SUITE 102 | SCOTTDALE ARIZONA 85260

FOR MORE INFORMATION CONTACT:



Randy Shell
Designated Broker
C 480.694.4100
randy@shellcommercial.com



Amanda Wright
Senior Associate
C 480.236.0037
amanda@shellcommercial.com



480.443.3992 | shellcommercial.com
16410 N 91st St | Suite 112
Scottsdale, Arizona 85260

The above is subject to prior sales and leasing. This information has been secured from sources we believe to be reliable, but we make no representation or warranties, expressed or implied as to the accuracy of this information.

FLOOR PLAN / FEATURES

8260 E GELDING DRIVE | SUITE 102 | SCOTTDALE ARIZONA 85260

FEATURES:

- Light, bright reception area
- One (1) private office
- One (1) restroom
- Includes two (2) covered parking spaces
- 100% HVAC warehouse with 10'x10' rollup door
- Zoned I-G, City of Scottsdale



NOT TO SCALE

All information furnished regarding property for sale, rental or financing is from sources deemed reliable, but no warranty or representation is made to the accuracy thereof and same is submitted to errors, omissions, change of price, rental or other conditions, prior to sale, lease or financing or withdrawal without notice. No liability of any kind is to be imposed on the broker herein. This information has been secured from sources deemed reliable, however, we make no warranties as to its accuracy.

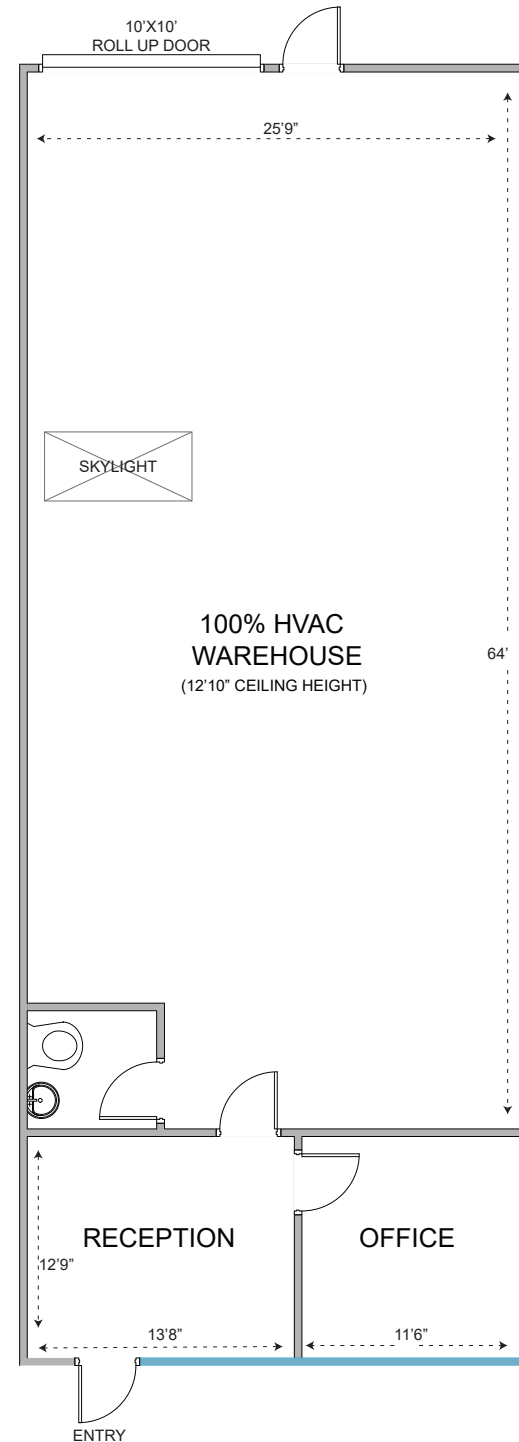

8260 E GELDING DRIVE | SUITE 102 | SCOTTDALE ARIZONA 85260



The above is subject to prior sales and leasing. This information has been secured from sources we believe to be reliable, but we make no representation or warranties, expressed or implied as to the accuracy of this information.